

NORDHAUS™

COMPACT CORDED 2 IN 1 VACUUM CLEANER

User Manual

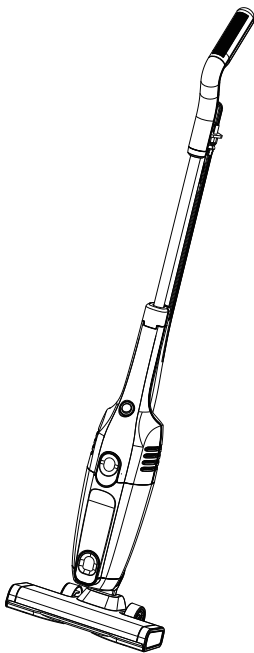

Please read this manual carefully before use.



Contents

Safety Instructions.....	1
Product Anatomy.....	2
Product Installation.....	3-4
Product Use.....	5-6
Product Maintenance.....	7-8
Technical Specifications.....	9
Common Failures.....	10

Safety Instructions

Please read the following safety instructions and follow all usual safety precautions before using this product.

The vacuum cleaner is for adult use only and is suitable for cleaning in a domestic environment. Always keep the vacuum cleaner in a dry place. All maintenance and repairs must be provided by an authorized service center.

Not for use by children.

If power supply cord is damaged, please cease usage immediately.

Packaging materials (e.g. plastic bags, etc.) should not be placed where children can reach them to avoid choking. In the event of an accident, unplug the product immediately and do not leave the defective product in working condition. This product can only be repaired at designated service centers, and is prone to other unsafe factors when repaired at non-authorized centers.

Do not use this vacuum cleaner in the following places or situations:

1. Wet places.
2. Flammable gas accessories.
3. When the casing shows visible signs of breakage.
4. Remove sharp objects or liquids.
5. Remove hot or cold ashes, lit cigarettes, etc.
6. Removes fine dust, such as that found in plaster, concrete, flour, hot or cold ashes.
7. Never place the vacuum cleaner in direct sunlight.
8. Avoid exposing the vacuum cleaner or power cord to excessive heat.
9. Never use the vacuum cleaner without a Hepa.

Using the vacuum cleaner under these conditions may cause serious damage to the product.

Such damage is not covered by the warranty.

Eco-friendly

When disposing of the product, please do not pile it up with general household garbage, but give it to an officially designated recycling center.

Product Anatomy

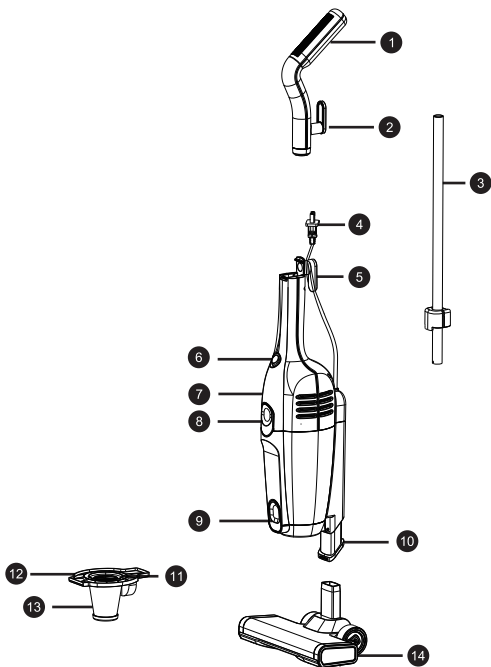

1.Handle

2.Upper hook

3.Metal push rod

4.Power cord

5.Lower hook

6.On/off

7.Body

8.Dustbin release button

9.Dustbin cover release button

10.Dust collection suction port

11.Shock pad

12.Lower hook

13.Hepa

14.Scrubber assembly

- Hold the handle and insert the limit post of the metal push rod into the port towards the back of the handle, after hearing the locking sound, the installation is successful.

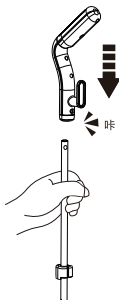

- To remove the handle, lift the metal push rod upward while holding the limit post with a hard object.

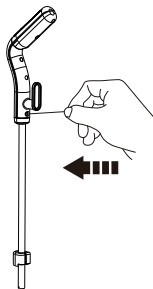

Installation of the handle assembly at the body

- Hold the body, open the lower hook at 90°, insert the installed handle assembly vertically into the body port, and then latch it with the lower hook for successful installation.

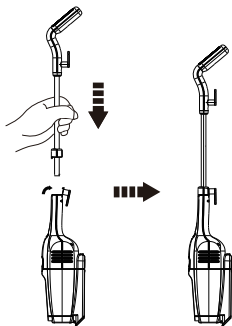

Product Installation

Installation of scrubber assembly

- Hold up the body and push the scrubber suction port up against the body's dust collection suction port to complete the installation.

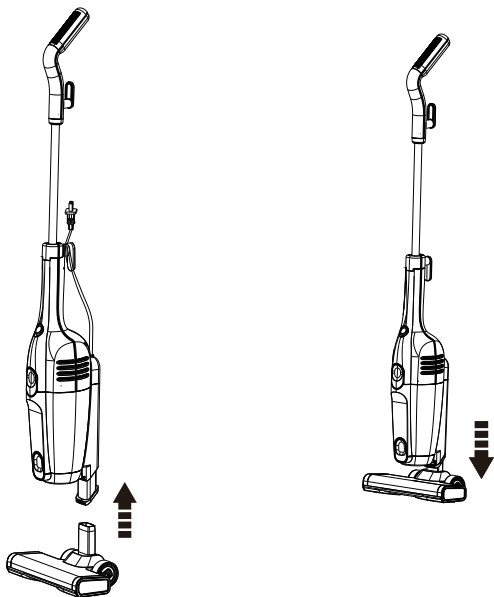

How To Use

1

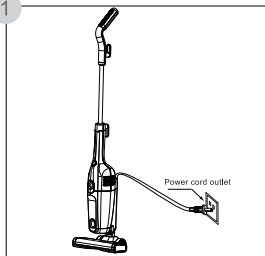

- Please make sure that all parts of the machine have been installed before use, and that the power cord is removed from the upper and lower hooks and inserted into the power outlet.

2

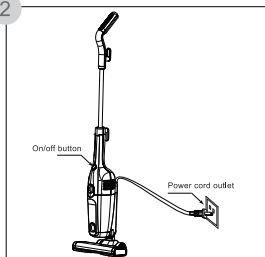

- Turn on the power on/off button

3

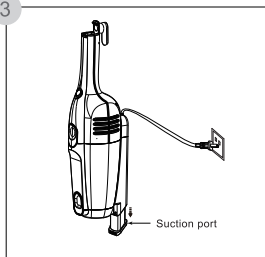

- If you need to adjust the length of the dust collection suction port during use, pull it out from the suction port.

How To Use

1

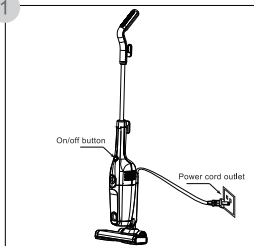

- Turn off the power switch.

2

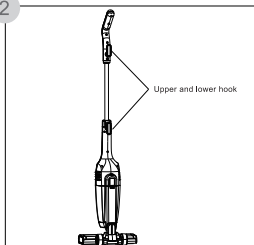

- After the product has been used, the power cord can be wrapped around the upper and lower hooks.

3

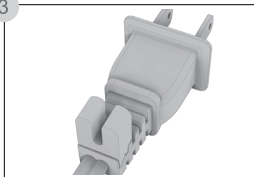

- The power plug can be fixed to the power cord.

Warning: To avoid injury, turn off the vacuum cleaner and unplug the power cord from the wall when not in use.

Product Maintenance

Cleaning the dust box and Hepa

Note: The dust box needs to be cleared and the Hepa cleaned regularly to ensure optimum machine performance.

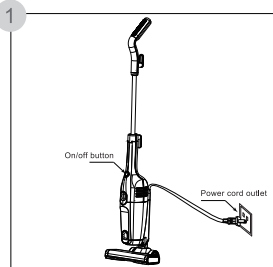

- Turn off the power on/off switch of the machine and then unplug it from the power outlet.

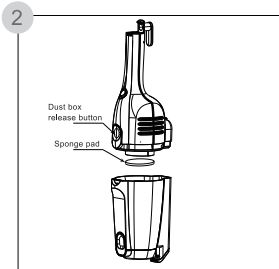

- After the machine is used, please clean out the dust from the dust box in time. Please hold the machine vertically and press the dust box release button.

Note: The sponge pad needs to be taken off and patted for dust.

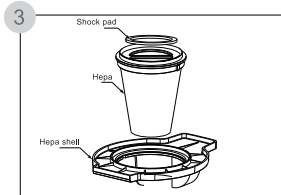

- Remove the shock pad, hepa, and hepa shell as shown.

Product Maintenance

1

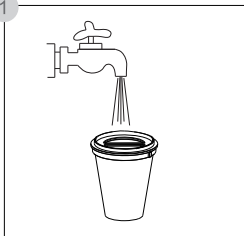

- Remove the hepa from the dust box and gently pat it clean, then rinse the hepa with cold water.

Note: Wait for the hepa to dry before putting it in the dust box.

2

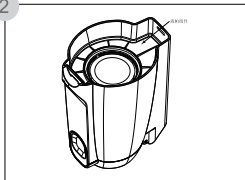

- Assemble the hepa shell, hepa, and sponge pad and fit them into the top of the dust box, and push down firmly.

3

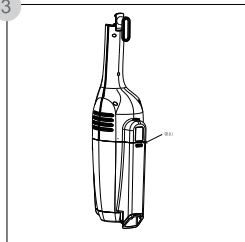

- Assemble the dust box to the machine, align the latch at the back and push up, the installation is successful when you hear a click at the latch.

NOTE: To maintain suction and cleaning performance, you can check the hepa periodically to make sure it is not clogged.



Note: Never operate the machine without a hepa. Doing so may damage the motor and void the warranty.

Technical Specifications

Main technical parameters

Product category	vacuum cleaner	Product model	V110
Rated voltage	230V~	Rated power	600W
Capacity	0.75L	Rated frequency	50/ 60Hz

Electrical schematic diagram

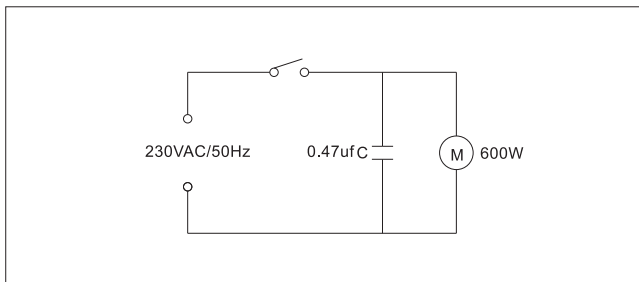

Packing list

Name	Quantity	Name	Quantity
Vacuum cleaner	1	Metal push rod	1
Scrubber assembly	1	Handle assembly	1
User Manual	1		

Common Failures

Warning Code List

The following corresponding phenomena and solutions will appear when the machine has some common malfunctions.

Failure	Cause	Solution
The machine doesn't work	The machine power cord is not plugged in securely.	Check the power outlet.
	The power outlet is not charged.	Check the circuit breaker.
	Whether the machine switch button is turned on and the electrical overheating protection device is activated.	After cleaning the hepa, place the machine in a cool place and leave it for about 40 minutes to restart the power.
Weak suction	The dust box is full, or the hepa has not been cleaned for a long time resulting in clogging.	Follow the maintenance instructions to clean the hepa and dust box.
	The supply voltage is unstable.	Use when the voltage has stabilized.
Dust coming out of the vents	The hepa unit in the dust box is broken or the hepa is not in place.	Stop use immediately and replace with a new hepa. Immediately stop use and put the hepa in place.