

# Instruction Manual

## 1 Mount the top wall bracket.

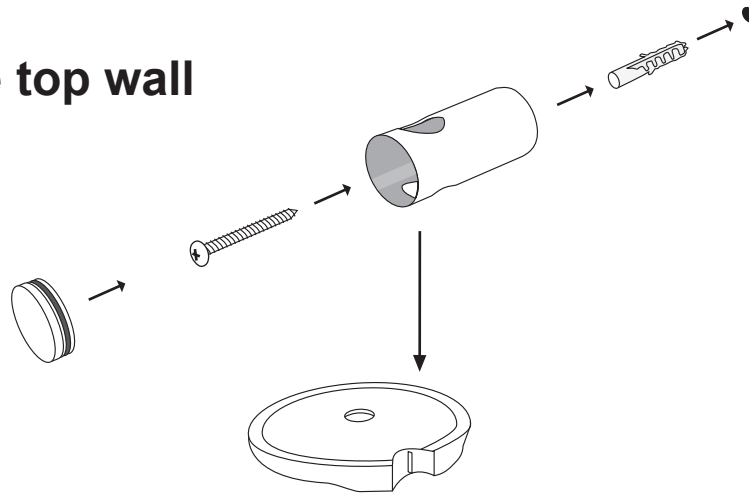

## 2 Fix the soap dish into the rail

Firstly fix 1/2 grey plastic part on the pole. The slot of soap dish is matched with the gap of grey plastic part. Then tighten it in your required height.

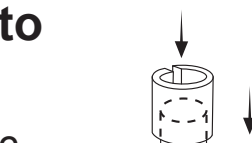

## 3 Insert the rail into the top wall bracket.

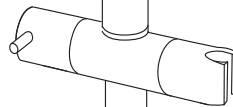

## 4 Mount the bottom wall bracket.

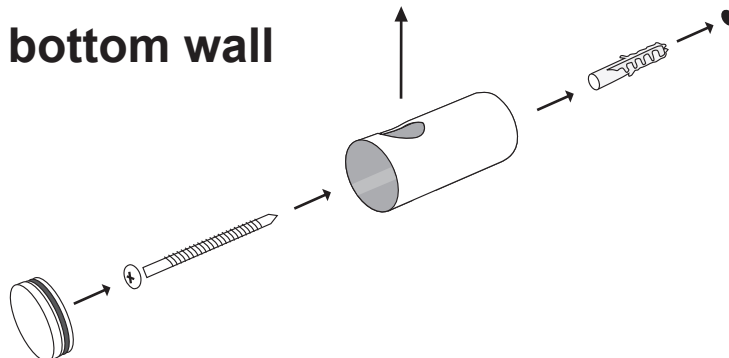

## 5 Fix the shower hose and shower head.

