

25mm PVC Venetian Blind

INSTALLATION INSTRUCTIONS

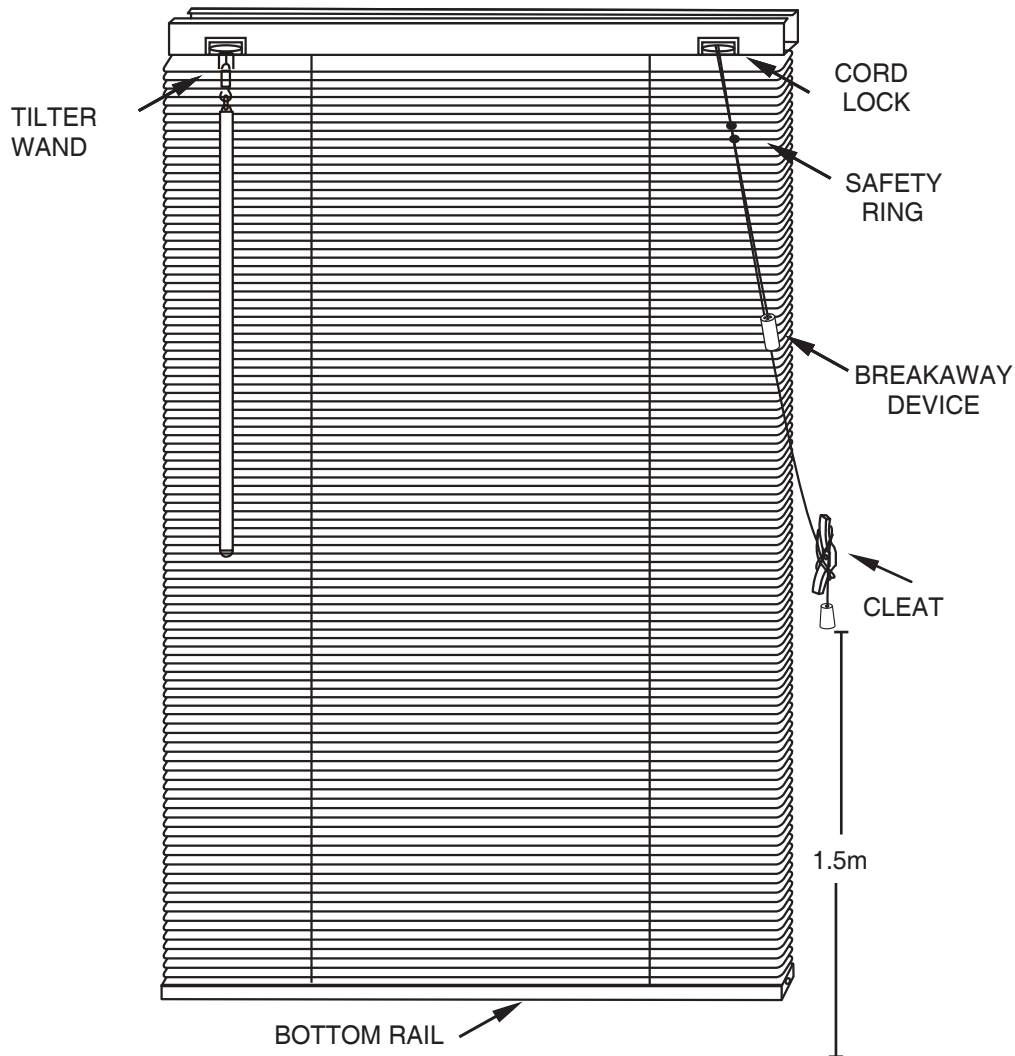

Blind width	Center Support
90cm	1
120-150cm	2
180cm	3

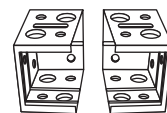

Bracket



Center Support

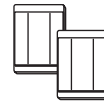

Bracket Face Plate

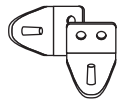

Hold Down Bracket



Screw



Cleat



Breakaway device

1. Install brackets

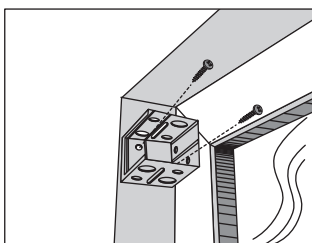

- Inside Mounting - Fit to the inside of the window frame.

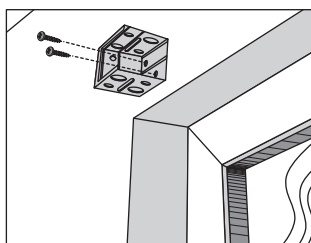

- Outside Mounting - Fit to the outside of the window frame.

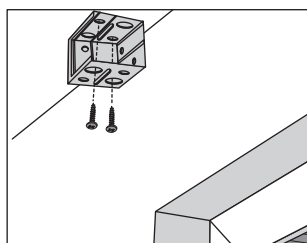

- Ceiling Mounting - Fit to the ceiling above the window frame.

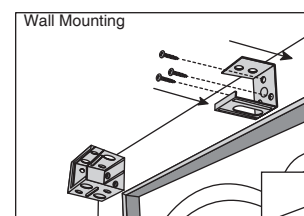

- Center Support(s) are provided for wide blind only.

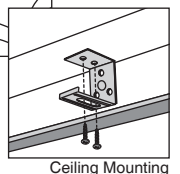

Ceiling Mounting

2. Place Blind into the Bracket.

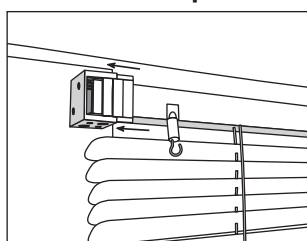
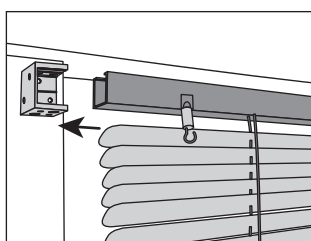
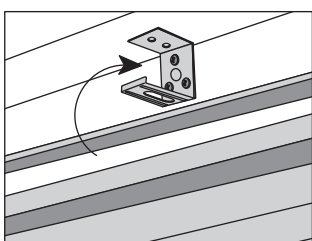

3. Slide the face plate into the bracket to secure the blind in place.

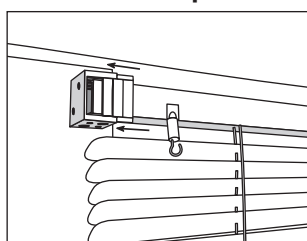
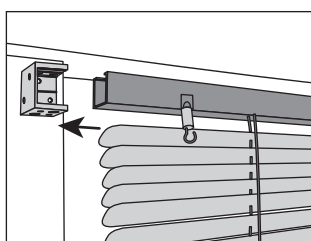
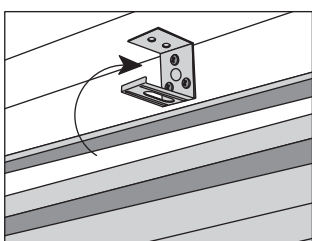

4. Cut to size

It is possible to trim the blinds to fit the width of an opening by up to 50mm on each side. A maximum of 25mm can be removed on each side of blinds.

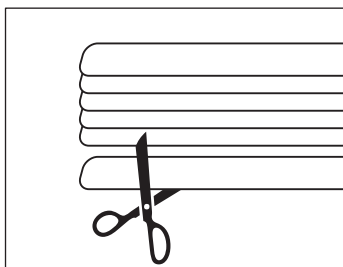

- Measure the amount by which you want to trim the blinds. You must cut equal amounts off either side of the blind.
- Using a hacksaw cut the head rail and the bottom rail.
- Measure and mark each slat carefully to ensure that each slat is cut to the same width.
- To achieve the best results and cut each slat individually, scissors may also be used.

5. How To Shorten

It is not necessary to remove excess slats for the blind to function normally. If appearance of the bottom rail and slats resting on the window sill is undesirable, proceed as follows:

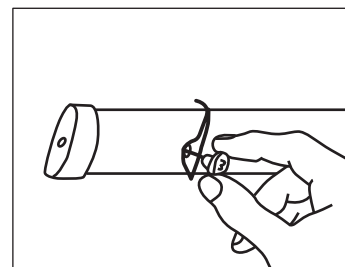

- Remove caps on bottom rail.
- Pull lift cords out of bottom rail and untie knots.
- Remove bottom rail, and then the desired number of slats.
- Reinsert bottom rail through ladder rungs and retie lift cords.
- Cut off excess ladders, allowing one extra rung. Tuck into bottom rail and replace caps.

6. How to operate

- Attach the tilter wand over the hook. Use the wand to adjust the vertical posi.
 - To raise or lower blind, pull cord to the left until cord lock releases. When desired height is reached, pull cord to the right and blind will lock. Slats should be horizontal when raising or lowering blind to prolong life of cords.
- tion of the slats by rotating the wand clockwise or anti-clockwise.

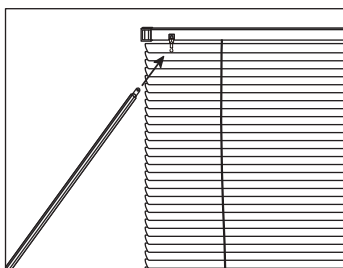

7. Install hold down bracket at the Bottom of the window (Optional).

Hold down brackets should be used only if blind is to be in a permanently lowered position. Fit the holes on the both ends of the bottom rail into the hold down brackets.

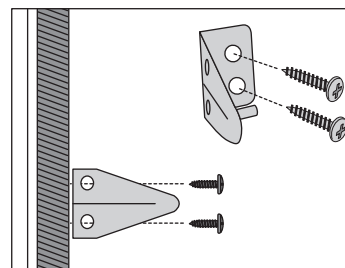

5. Child-Safety instruction

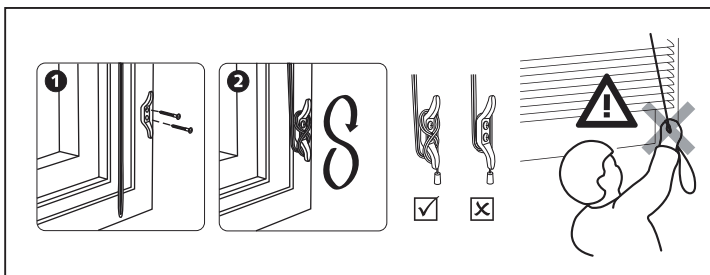
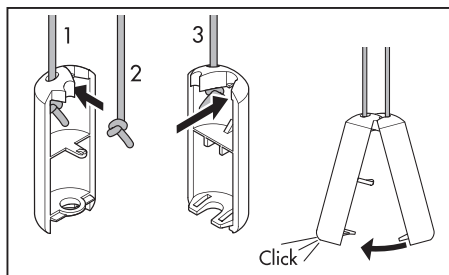
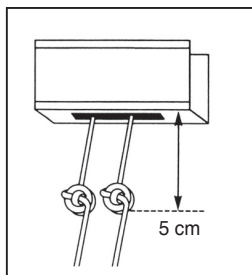

- **Safety Ring:** Make sure the position of safety ring will be always no more than 5cm below the headrail after blinds adjusting.
- **Breakaway device:** The safety breakaway device has been installed on the pull cord to keep multiple cords together for ease of use and to help prevent the risk of strangulation from loops. Regularly check the functionality of the breakaway device. **NEVER** tie cords together as this will result in a fixed loop which is a strangulation hazard.
- **Fit the child-safety cleat:** The child safety cleat (see ❶) is designed to keep loose cords out of reach of young children and avoid the risk of strangulation. The cleat shall be installed as close to the headrail as possible and, in all cases, not less than 1.5m from the floor. Mark and secure the cleat with fixings provided, ensure that the fixing is secure. Each time the blind is operated the cords should **ALWAYS** be wrapped around the cleat to ensure that they cannot be reached by young children. Check the cords at regular intervals to ensure they have not become entangled and formed a loop. Please note: the cleat pictured may differ from that supplied.
 - ★ Wrap the cord tightly around the cleat in a figure of 8 motion as shown ❷.
 - ★ When nearing the end of the cord, loop the remaining length over the body of the cleat allowing the minimal amount of cord to drape from the cleat as possible. (You may need to repeat the figure of 8 motion again).

! WARNING



- Young children can be strangled by loops in pull cords, chains, tapes and inner cords that operate the product.
- To avoid strangulation and entanglement, keep cords out of the reach of young children. Cords may become wrapped around a child's neck.
- Move beds, cots, playpens, high chairs and furniture away from areas where a child could reach window covering cords.
- Do not tie cords together. Make sure cords do not twist and create a loop.
- Persons in charge of children are ultimately responsible for following the safety instructions provided by the manufacturer and to use any safety device provided.
- Children can strangle if the safety device is not installed or not correctly installed and adjusted.
- Read the instructions carefully before installation.
- Headrails should not be installed less than 1.5m from the floor, the accumulation system shall be installed as close to the headrail as possible and in all cases, not less than 1.5m from the floor.
- Care should be taken when handling tools and fitting the blind. The fitting pack contains small pieces which might cause a choking hazard.