

Xiongli Decoration Co., Ltd	
Size:	255 (W) x 130 (H)mm
Color:	100K Die-cut
Material:	Paper 6 Pages
Coating:	Matt
Item:	071395
Date:	09-09-2021
Designer:	Tom

Front

Welltool[®]
HD IN -CAR CAMERA
Instructions Manual
PLU-071395

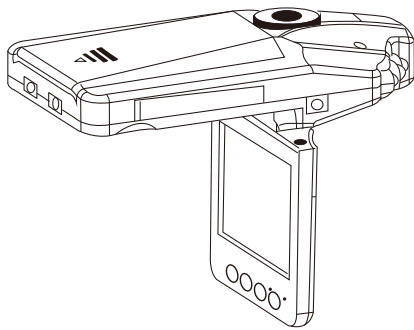

Please read these instructions thoroughly before use and retain for future reference.

Thank you purchasing this Weltool HD In-Car Camera.

In order to help you operate it correctly, please read this instruction carefully before using.

Product Picture and Function

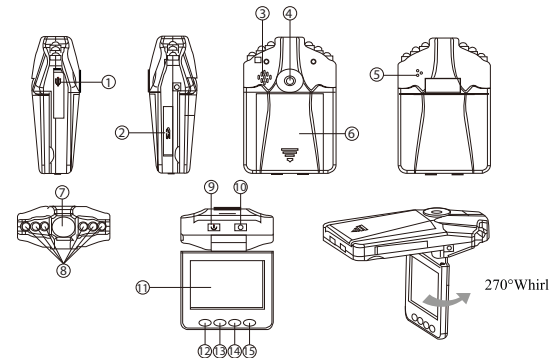

1. Mini USB Slot

2. SD/MMC Card Slot

3. Speaker

4. Mount hole

5. Microphone

6. Battery cover

7. Lens

8. IR LED
9. ON/OFF Power Switch

10. REC/SNAP Switch

11. 2.5 inch LCD

12. Menu

13. Down

14. Up

15. Mode Button

IN THE BOX:

- HD In-Car Camera
- Windscreen Mount
- Car Charger (12/24V cigarette charger transfer to 5V adaptor)
- USB Charging Cable
- Li-ion Rechargeable Battery (3.7V / 1020 mAh)
- 16GB Micro SD Card with Adaptor
- Instruction Manual

OPERATION:

Two Power Options

1. Use Li-ion Rechargeable Battery

Car camera can be activated after it has been placed on the vehicle by pressing the Power Switch Button (9) for 3 seconds and turn off by pressing it again.

Charging: connect with USB cable of car charger
2. Connect with Car Charger

Car camera will record automatically when the car starts. Turn off and save the last file when the car stops.

RECORDING:

Car camera will enter into defaulted recording mode when turned on. The indicator light will flash during record, the file is saved in the SD/MMC card. To stop recording, press REC/SNAP Button (10) or ending when car stops.

CAMERA MODE:

Turn on the Car Camera and press Mode Button (15) to change Camera mode. Take photo by pressing REC/SNAP Button (10).

PREVIEW MODE (PREVIEWING AND DELETE):

- Turn on the Car Camera and press Mode Button (15) to change into Preview Mode
- Press UP (14) or Down (13) to select the previewed file(s).
 - If it is a video file, it can play or stop by pressing REC/SNAP Button (10). If you want to delete it, press Menu Button (12) to enter into "Delete Mode", then select "Delete One / Delete All" by REC/SNAP Button (10); and Up (14) / Down (13) and confirm to delete the file by pressing REC/SNAP Button (10).
 - Also, it can select Thumbnail mode and volume (from 0 to 6) under Preview Mode.

Back

SETTING THE FUNCTIONS:

Turn on the Car Camera and press Menu Button (12) under Video Mode or Camera Mode to enter into setting inference. Confirm selection by pressing REC/SNAP Button (10) and select Up (14) / Down (13) for the following setting. Press Menu Button (12) again to exit once finished.

A. Video Output

Under video mode, press Menu Button (12) to enter "Video Output" setting.

1. **Resolution:** Select (HD 1080P / 720P / VGA)

2. **Time Stamp:** Select (Off / On)

3. **Motion Detect:** Select (Off / On)

Note: When selecting motion detect function, it will be recording automatically, if there is movement and stop recording if there is no movement.

4. **Video Time:** Select (Off / 1 min / 3 min / 5 min / 10 min) to determine the length of each video section.

5. **Voice Record:** Select (On / Off)

B. Setting

Whether under Video Mode or capture mode, press Menu Button (12) twice to enter into Setup Interface.

1. **Format:** Select (Cancel or Execute) to format the memory card

2. **Language:** Select (English / Traditional Chinese / Simplified Chinese / Japanese)

3. **Screen Saver:** Select (Off / 1 min / 3 min / 5 min)

4. **Auto Off:** Select (Off / 1 min / 3 min / 5 min)

5. **System Reset:** Select (Cancel or Execute) for system reset

6. **Light Frequency:** Select (50HZ / 60HZ)

7. **Date Input:** Set correct recording Date and Time by REC/SNAP button (10) and Up (14) / Down (13)

8. **USB Mode:** Select (PC Cam / Disk Drive)

Remark: IR LED function: Turn on the Car Camera and press Mode Button (15) under Video mode, you can select Day or Night to press the On / Off Button (9).

C. Capture

Under camera mode, press Menu Button (12) to enter "Capture" Size setting. Select (3M / 2M / 1.3M / VGA)

NOTE:

1. Please insert the SD/MMC card before recording.

2. This Car Camera records in a cycle. If you choose 1/3/5/10 minutes as a storage time, when the storage medium is full, it will record from the beginning again and erase over the previously recorded material automatically. It will have 3 seconds pause time, and the contents in the 3 seconds will not record.

3. Because of the Car Camera is DV5V input, please use the attached car charger. It has adaptor 12V/24V transfers to 5V already.

TECHNICAL SPECIFICATIONS:

1. Recording resolution: HD 1080P / 720P / VGA

2. Video format: AVI

3. Repeat storage by section: 1/3/5/10 minutes

4. Power source: Li-ion Rechargeable Battery or 12/24V Car Charger

5. Supports SD/MMC card (from 1GB up to 32GB)

6. Microphone: can record sound

7. 2.5 Inch LCD: 270° Whirl (clockwise 90° Whirl / counter-clockwise 180° Whirl)

A Suggestion:

The Car Camera resembles a computer in features.
Restart and reset the camera if it stops working during usage.

No further notice will be given for any modification of the technical specification.

GUIDELINES FOR PROTECTION OF ENVIRONMENT



This appliance should not be put into the domestic garbage at the end of its useful life, but must be disposed of at a central point for recycling of electric and electronic domestic appliances. This symbol on appliance, instruction manual and packaging puts your attention to this important issue. The materials used in this appliance can be recycled. By recycling used domestic appliances you contribute an important push to the protection of our environment. Ask your local authorities for information regarding the point of recollection.

Made in China